

# Old Smithville Burying Grounds

Alphabetical Listing of Graves

southport historical society

Compiled by Charles Christianson  
and Martha Johnson

## Legend and Map

**Last Name:** The last name on the Plot Marker. If it is not found, then it becomes Unknown, if there is a grave, but it is unmarked, then it becomes Unmarked.

**First Name:** The first name on the Plot Marker.

**Middle/Initial:** The middle name or initial on the Plot Marker.

**Other Mid Name:** The other middle name or initial on the Plot Marker if there is more than one (1).

**Title:** The title of the person on the Plot Marker, if there is one.

**Birth Date:** The date closest to what the Plot Marker has on it. 00/00/0000 means that there is no birth date given.

**Death Date:** The date that is found on the Plot Marker. 00/00/0000 means that there is no death date given.

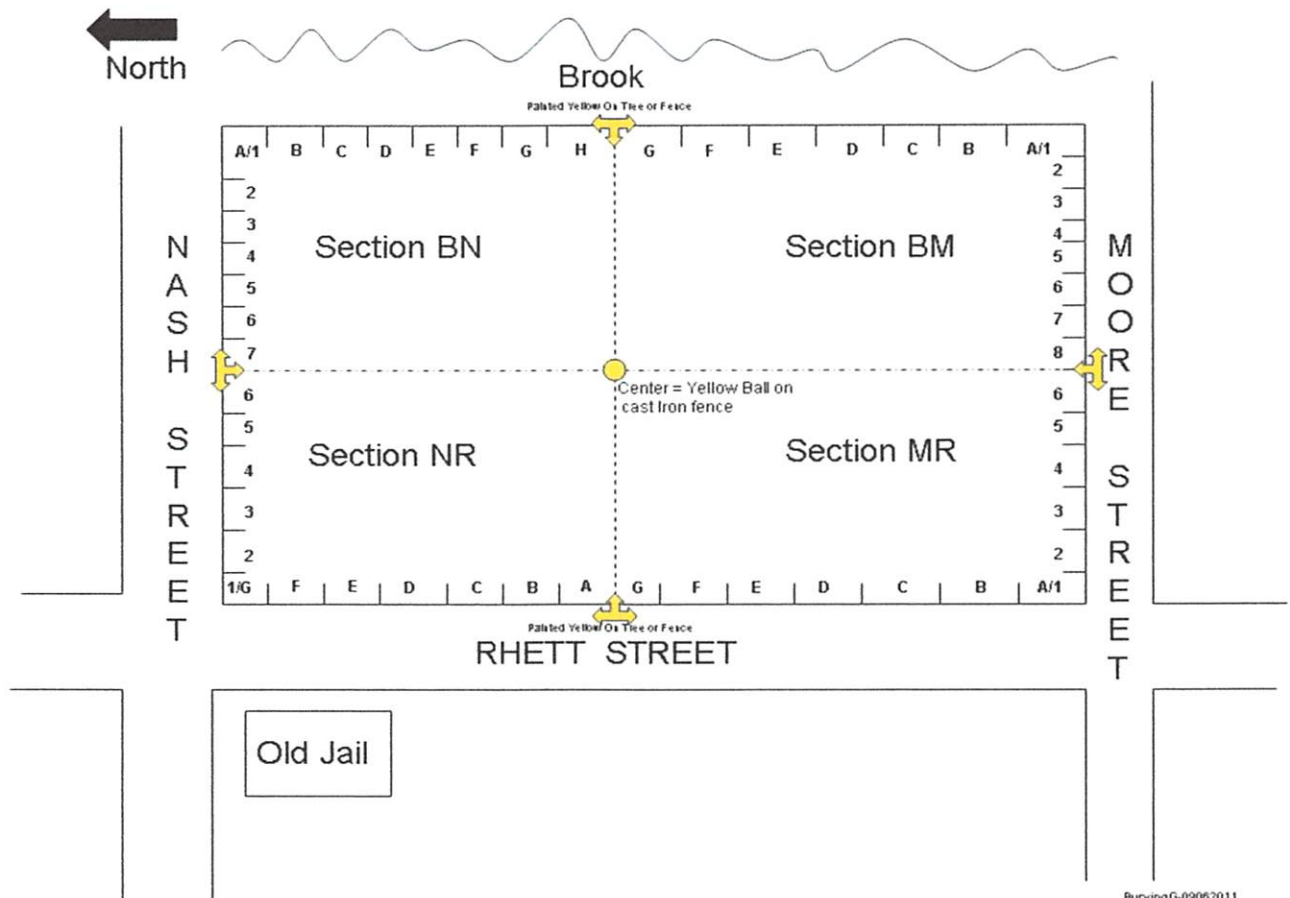

**Quad Loc:** The four quarters or quadrants of the cemetery. Quarters are Nash-Rhett (NR) (north west), Moore-Rhett (MR) (south west), Brook-Moore (BM) (south east), Brook-Nash (BN) (north east).

**Loc:** Fences are to be used for the grid. For the NR (Nash-Rhett) quadrant, the alpha characters run from the double gate next to the Cornelius Smith Plot (large marble cross) to Nash Street. Numbers for the NR quarter run along Nash street until the Yellow marks on Tree/fence. The Center position is the left side post (with back to Rhett street) of the lot with the cast iron fence. The section (or Grid) that is seen from the observer using the alpha letters on the fence, and the numeric on the other quadrant fence. Standing in one place, facing the direction of the fences. All Plot Marker locations are within about 30 feet of two character location.



## A LAST NAME

Last Name	First Name	Middle/Initial	Other Mid Name	Title	Birth Date	Death Date	Quad Loc	Loc
Adams	David	Columbus			05/31/1914	07/31/1989	MR	D1
Adams	Denie	Mae			07/14/1914	00/00/0000	MR	D1
Adkins	Addie				00/00/1892	01/21/1885	NR	A6
Adkins	Bertrum	B.			07/19/1889	07/23/1912	NR	D5
Adkins	Ellen	Genevieve			00/00/1888	06/07/1888	NR	D5
Adkins	J	N			08/15/1827	02/09/1994	NR	D3
Adkins	James	Brooks			00/00/1856	02/15/1887	NR	D3
Adkins	Minnie				00/00/1860	02/07/1882	NR	A6
Adkins	Price				00/00/0000	00/00/0000	NR	A6
Adkins	R	D			00/00/0000	00/00/0000	NR	A6
Aldredge	James	B			07/09/1908	07/09/1979	BN	E1
Aldredge	James	Bell			12/23/1907	07/09/1979	BN	E1
Aldredge	Miriam	Pinner			07/15/1909	11/13/1991	BN	E1
Aldridge	Lee	B			00/00/1874	00/00/1932	BN	G2
Aldridge	Pearl	Potter			02/07/1914	12/24/1990	BN	G3
Aldridge	Walter	Lee			11/15/1913	12/31/2002	BN	G3
Aldridge	Zulima	W			00/00/1879	00/00/1961	BN	G2
Allen	Joseph	Walter			00/00/1811	00/00/0000	NR	G2
Anderson	Alfred	J			00/00/0000	04/05/1948	NR	G7
Anderson	John				01/01/1771	08/11/1842	NR	B6
Anderson	John	R			01/01/1800	08/26/1824	BN	I7
Anderson	Marie				05/21/1898	08/23/1928	BM	B3
Anderson	Mary				01/01/1776	10/13/1834	NR	B6
Anderson	William				03/09/1883	01/21/1937	BM	B3
Anderson	Willie	Marie			01/07/1918	03/23/1920	BM	B3
Arnold	Albert	A.		Sr	12/18/1878	02/17/1964	BM	D1
Arnold	Annie	M	Boyd		05/15/1878	08/20/1949	BM	D1
Arnold	Cloah	C	Weeks		03/10/1885	12/21/1959	BN	I7
Arnold	Cora	E			07/12/1902	02/18/1935	BN	E2
Arnold	Dora	K.			08/15/1883	09/14/1962	BM	D1
Arnold	Elizabeth				01/00/1856	03/09/1932	BM	C1
Arnold	Elizabeth				00/00/0000	00/00/0000	BM	C6
Arnold	Emma	Jane			11/23/1895	06/18/1944	BM	C1
Arnold	Fred	D			02/13/1899	06/25/1926	BN	E1
Arnold	Fred	V			10/31/1902	10/22/1933	BN	E1
Arnold	George	W.			04/21/1890	09/23/1967	BM	C1
Arnold	James	S.			05/20/1901	01/27/1956	BM	C1
Arnold	Joseph	F.			06/04/1854	08/20/1929	BM	C1
Arnold	Joseph	G			00/00/0000	00/00/0000	BM	C6
Arnold	Joseph	N.			05/18/1886	07/18/1950	BM	D1
Arnold	Arnold	Lot			00/00/0000	00/00/0000	MR	B5



## B Last Name

Last Name	First Name	Middle Initial	Other Mid Name	Title	Birth Date	Death Date	Quad Loc	Loc
Baker	Carrie				00/00/0000	00/00/0000	BN	H4
Baker	Julia				03/29/1825	10/15/1869	BN	H5
Baker	Mary	L			06/21/1808	06/21/1832	BN	H3
Baum	S.	Helen			11/11/1909	12/12/1913	NR	D1
Bell	Elias				06/11/1797	09/18/1841	BN	F5
Bell	George	W			02/18/1848	10/04/1940	BN	B5
Bell	J	A			11/00/1839	11/07/1913	BN	C5
Bell	Mary	J			05/11/1849	06/04/1896	BN	B5
Bell	William				07/06/1823	01/01/1854	BM	F5
Bellamy	Ida	Leola			09/08/1898	06/27/1898	MR	A1
Bellamy	Rufus	Ellis			10/11/1895	10/00/1897	MR	A1
Bellflower	Ann	Creech			08/25/1918	10/18/1969	BN	F1
Bensell	Caroline				02/25/1824	03/11/1896	MR	D5
Bensell	Joseph				04/01/1835	12/11/1872	MR	B3
Bensell	Joseph	W			00/00/0000	12/11/1872	MR	F4
Bensell	Richard	T			03/12/1853	02/14/1914	MR	E5
Bensell	Thomas				11/20/1879	06/15/1881	MR	E4
Berg	Jens				05/20/1868	01/08/1942	NR	D1
Berg	Mary	Woodside			08/30/1868	09/08/1946	NR	D1
Betts	Edward	Andrew	Lehew		12/11/1858	08/24/1861	BN	F5
Biddlecomb	Edwin	Robinson			02/22/1932	04/11/1933	BM	B1
Blake	Mary	Amanda			09/07/1800	08/05/1825	MR	D6
Blancy	Benjamin				00/00/0000	00/00/0000	NR	A5
Bond	Samuel				06/14/1808	05/07/1851	NR	A6
Bowen	A	T			10/20/1868	05/04/1896	BN	B6
Bowen	A.	T.			05/08/1868	05/09/1896	BN	B6
Bowen	Louis	F.			04/10/1870	06/23/1893	BN	B6
Bowen	Thelma				07/03/1900	01/31/1903	BN	B6
Bowen	Wm.	F.			03/08/1876	10/19/1887	BN	B6
Bowers	Andrew				03/22/1822	02/18/1886	MR	A3
Bowers	Dora				02/11/1865	03/21/1865	MR	A3
Bowers	Mary	Louisa			02/03/1857	12/22/1863	MR	A3
Boyer	Rebecca	A			02/07/1854	07/08/1886	MR	G6
Branton	Amelia				01/01/1806	10/28/1862	MR	B3
Branton	John				01/01/1800	10/28/1862	MR	B3
Brewer	Homer	Weeks		Jr	03/04/1929	10/24/1991	BM	F1
Brinkman	M.	A.			00/00/0000	00/00/0000	MR	D1
Brinkman	Thomas	W			04/01/1840	12/11/1872	MR	B3
Broom	Infant				09/09/1930	09/09/1930	NR	B5
Brown	Anna	Taylor			02/27/1918	09/29/2001	BM	A7
Brown	Caroline	Maria			04/11/1833	08/21/1862	BM	G8
Brown	John				01/01/1756	01/31/1834	BM	G8
Brown	John				01/01/1788	08/14/1871	BM	G8



Last Name	First Name	Middle Initial	Other Mid Name	Title	Birth Date	Death Date	Quad Loc	Loc
Brown	Napoleon	Bonaparte			02/21/1824	10/22/1836	BM	G8
Brown	Rebecca	Peyton			10/25/1788	01/13/1892	BM	G8
Brown	Robert	W			11/00/1828	09/29/1864	BM	G8
Brunson	Elbert	B		Sr	11/19/1898	08/07/1950	BN	D6
		St.						
Brunson	Elizabeth	George			11/03/1900	05/28/1988	BN	D6
Bryant	Irene	Woodside			01/29/1913	02/23/1978	BN	G7
Burriss	Carrie	Vance			04/01/1862	09/30/0000	NR	F6
Burriss	Frederick	Thomas			08/14/1869	11/04/1958	BN	D5
Burriss	J	E			03/28/1875	01/18/1898	BN	D5
Burriss	Jacob	Dawson			07/25/1857	06/15/1893	NR	F6
Burriss	Joseph	Newton			02/12/1827	10/14/1901	NR	F6
Burriss	Mary	A			06/11/1813	02/17/1906	NR	D5
Burriss	Mary	Jane			01/11/1833	02/06/1903	NR	F5
Burriss	Nancy	Jane	Elmore		00/00/1845	00/00/1936	BN	D5
Burriss	Phillip				04/13/1892	09/30/1892	NR	F6
Burriss	Thomas	Gray			00/00/1843	00/00/1925	BN	D5
Butler	Minnie	B.			00/00/1886	06/14/1980	BN	E4
Butler	William	G.			00/00/1869	00/00/1947	BN	E4



## C Last Name

Last Name	First Name	Middle /Initial	Other Mid Name	Other Title	Birth Date	Death Date	Quad Loc	Loc
Caison	John	Gorden			03/01/1889	03/06/1955	MR	E5
Caison	Lillian	Bensell			08/27/1886	04/18/1960	MR	E5
Calder	John	R			02/03/1913	11/22/1997	BM	F4
Calder	Nora	Lund			06/28/1912	08/17/1980	BM	F4
Caraway	Rebecca				10/03/1821	12/10/1895	NR	F6
Carr	Susan	Dosher			01/11/1872	01/02/1964	NR	B4
Carr	Thomas	Beals			12/30/1871	02/23/1928	NR	B4
Carrick	Andren				00/00/0000	00/00/1804	BM	D8
Carrick	Andren				00/00/0000	00/00/1804	BM	F8
Carrier	Mary	F			01/04/1868	08/18/1953	BN	G4
Carrier	Ozen				11/24/1844	10/06/1936	BN	G4
Carrier	Robbins				00/00/0000	00/00/0000	BN	G4
Carver	James	N		Jr	07/30/1853	07/30/1885	MR	F3
Casaletta	Antonio				00/00/1863	08/23/1882	BM	B6
Christofferson	Harry	S			11/17/1891	09/05/1894	NR	E4
Church	James	B			06/14/1877	02/14/1965	BN	G6
Church	Laura	De			04/15/1874	03/16/1941	BN	G6
Clemmons	Elizabeth	Woodside			10/01/1841	10/24/1914	NR	D1
Clemmons	Ellen				08/17/1844	10/01/1880	NR	F1
Clemmons	J.	H.			02/21/1831	08/23/1914	NR	F1
Coleman	Dorothy	Mae	Potter		03/10/1916	07/16/1917	BM	E3
Colman	David				08/09/1856	11/21/1915	BM	A8
Cooker	Ida	Gertrude			09/22/1883	05/15/1909	BM	D8
Cooker	John	Alonza			01/01/1840	04/17/1908	BM	D8
Corlette	Harry	C		Sr	05/05/1853	11/25/1930	BN	D3
Corlette	Harry	C		Jr	08/30/1898	06/27/1947	BN	D3
Corlette	Louise	W			04/11/1868	08/01/1951	BN	D3
Cottrell	Leah	R	Weeks		00/00/1866	00/00/1923	BN	H6
Cox	Annie				02/26/1867	12/20/1934	BN	H1
Cox	Asa				02/27/1867	07/11/1935	BN	H1
Cox	Katie	T			00/00/1894	00/00/1983	BN	H5
Cox	Marcella				10/18/1890	06/30/1954	BN	H4
Cox	Mary				00/00/1862	00/00/1933	BM	C5
Cox	Peggy			Mrs	08/01/1765	09/16/1823	BM	E7
Craig	Mary	Caledonia			00/00/0000	00/00/0000	NR	C3
Crammer	Allie	G.			06/06/1838	03/05/1905	MR	F4
Crammer	Edward				04/21/1816	07/26/1891	MR	F4
Cranmer	Blanna	Mathews			11/17/1907	09/04/1979	BM	B7
Cranmer	Edward	Henry			02/22/1871	09/23/1942	BM	B7
Cranmer	James	Pierce			09/06/1908	04/14/1998	BM	B7
Cranmer	Jeanette	Stacy			04/16/1921	04/27/1938	BM	B7
Cranmer	Kate	Stuart			11/11/1906	01/20/1916	BM	B7
Cranmer	Mary	Elizabeth			02/26/1900	07/31/1903	BM	B7



Last Name	First Name	Middle /Initial	Other Mid Name	Other Title	Birth Date	Death Date	Quad Loc	Loc
Cranmer	Mary	Pearce			07/21/1878	09/25/1863	BM	B7
Cranmer	Paul	Morris			08/26/1912	02/22/1986	BM	B7
Crapon	Carrie				00/00/0000	00/00/0000	MR	B7
Crapon	Catherine				12/01/1795	08/29/1872	MR	B6
Crapon	Eva				00/00/0000	00/00/0000	MR	B7
Crapon	Mary	Carrie	Eva		00/00/0000	00/00/0000	MR	B7
Cratch	Eliza				01/01/1804	01/29/1818	BM	D8
Creech	Benjamin	H			08/19/1889	01/28/1957	BN	F1
Creech	Charles	Gilbert			12/11/1921	02/19/1940	BN	I7
Creech	Dillon	Paterick			04/16/1994	04/16/1994	BN	F1
Creech	Donald	Louis			09/05/1943	02/06/1944	BN	F1
Creech	Eslie	L			02/24/1899	12/09/1986	BN	F1
Creech	Infant				04/19/1932	04/19/1932	BN	F1
Creech	Louis	B			03/17/1919	07/25/1981	BN	F1
Creech	Myrtle	C			11/06/1906	01/02/1973	BN	I7
Croom	Helen	McKeithan			00/00/1907	00/00/1955	NR	E1
Cumbee	Ephraim				00/00/1878	00/00/1951	BN	A5
Cumbee	Mary	A			08/09/1878	06/08/1936	BN	A5
Cumbee	Richmond				00/00/1907	00/00/1956	BN	A5
Curtis	Nathaniel				01/01/1757	03/14/1870	MR	G2
Curtis	Sarah	C			01/01/1833	01/31/1861	MR	G2
Curtis	Sarah	Twining			02/12/1836	12/25/1875	MR	G2



## D Last Name

Last Name	First Name	Middle /Initial	Other Mid Name	Other Title	Birth Date	Death Date	Quad Loc	Loc
Dabney	Emiline	Louisa			06/03/1811	09/19/1814	MR	C4
Dallas	Robert	E			07/02/1877	08/07/1935	BN	E1
Danford	Daniel	Clarence			04/14/1907	06/18/1981	BM	A4
Danford	Genevieve	Watson			04/12/1912	02/18/2005	BM	A4
Daniel	Enoch	B			02/01/1831	12/08/1880	BN	H8
Daniel	Ida	Robbins			06/12/1865	05/31/1952	NR	D1
Daniel	J	N			12/14/1865	04/05/1936	NR	C1
Daniel	James	B			02/14/1861	04/29/1863	BN	H8
Daniel	John	C			05/02/1859	05/23/1860	BN	H8
Daniel	Joseph	N		Jr	09/18/1894	10/18/1905	NR	C2
Daniel	Lucy	V			04/07/1863	10/22/1889	BN	H8
Daniel	Roy	C			08/12/1900	03/27/1953	NR	C1
Daniel	Susan	B			08/04/1967	09/17/1871	BN	H8
Daniels	Edie	Gause			00/00/1867	00/00/1936	NR	D6
Daniels	Joseph				03/04/1892	05/22/1894	NR	F6
Daniels	Rebecca	G			06/04/1863	02/03/1899	NR	F6
Davis	Alice				00/00/0000	00/00/0000	BM	C6
Davis	Annie	Pearce			11/13/1885	05/06/1946	MR	D2
Davis	Annie	Ray	Mayer		09/02/1872	10/09/1905	BM	F5
Davis	Bobbie	Blackwell			00/00/0000	05/12/2006	BM	E3
Davis	Catherine	Legg			00/00/1847	00/00/1909	MR	F1
Davis	George	Wilson			12/30/1870	08/06/1871	MR	C2
Davis	Irene	M			09/23/1888	03/15/1957	MR	E1
Davis	Isaac	S			00/00/1846	00/00/1932	MR	F1
Davis	J	Ike			12/10/1881	06/30/1966	MR	E1
Davis	Julius	D			01/15/1850	01/10/1927	MR	C2
Davis	Katharine				06/27/1896	02/08/1918	BM	F5
Davis	Little	Minnie	Ray		00/00/0000	05/27/1939	BM	F5
Davis	Mary	Caldonia	Swain		04/27/1850	07/15/1931	MR	C2
Davis	Mary	Rowena			01/22/1888	08/31/1889	MR	C1
Davis	Minnie	B.			00/00/0000	12/06/1946	BM	F5
Davis	Ned	F			06/28/1899	09/07/1899	BM	E5
Davis	Robert	W		Jr	07/18/1875	06/09/1939	BM	F5
Davis	Rollins	S			03/05/1885	01/14/1914	BM	C6
Davis	Simon	S			07/06/1840	10/03/1911	BM	C6
Davis	Thelma	McRachen			11/11/1905	01/25/1991	BN	I2
Deseife	Rainer	Hans			06/06/1946	09/16/1996	OJ	Shf
Dickson	Ann				00/00/0000	09/28/1921	BM	A8
Dosher	Agnes				00/00/0000	00/00/0000	BN	G6
Dosher	Alvin	Wayne			11/29/1950	12/09/1993	NR	E2
Dosher	Caroline				00/00/1867	00/00/1933	BN	G6
Dosher	Catherine	Corlette			10/21/1887	03/01/1976	NR	F6
Dosher	Charles				04/01/1850	04/13/1877	MR	B3
Dosher	Charles	G			00/00/1821	00/00/1895	NR	F6



Last Name	First Name	Middle /Initial	Other Mid Name	Other Title	Birth Date	Death Date	Quad Loc	Loc
Dosher	Eliza	J			02/05/1865	02/25/1865	BN	F5
Dosher	Evelyn	Smith			08/18/1913	02/11/2000	NR	E2
Dosher	Infant				10/14/1896	10/20/1896	NR	C4
Dosher	James	Henry			07/13/1843	06/23/1934	NR	F6
Dosher	Jesse			Mason	09/17/1901	08/03/1975	NR	E2
Dosher	John	Julius			09/16/1826	09/16/1892	BN	G6
Dosher	Leslie	May			12/20/1891	10/18/1893	NR	C4
Dosher	Lillian	James			04/11/1885	10/19/1981	NR	F6
Dosher	Lizzie	Barnett			02/18/1885	02/18/1899	BN	G6
Dosher	Margaret	A			09/07/1861	12/30/1945	NR	E2
Dosher	Mary	A			03/01/1842	07/00/1920	BN	G6
Dosher	Mary	P			00/00/1853	00/00/1939	BN	E4
Dosher	Rebecca				10/04/1848	01/25/1916	NR	F6
Dosher	Richard			Sr	00/00/0000	06/16/1893	NR	A6
Dosher	Richard				04/24/1902	06/19/1902	NR	C4
Dosher	Richard				00/00/1864	00/00/1927	NR	C4
Dosher	Sadie				03/25/1882	09/08/1910	MR	F1
Dosher	Sarah				12/29/1818	12/29/1859	BN	F5
Dosher	Sue	D			01/17/1869	04/04/1920	NR	C4
Dosher	Susan	D			00/00/1825	00/00/1903	NR	F6
Dosher	Susie				00/00/0000	00/00/0000	BN	G6
Dosher	William	J			04/08/1863	03/04/1933	NR	E2
Dosher	William	S		Billy	00/00/1852	00/00/1897	BN	E4
Dowling	Donna	Marie			05/07/1954	05/07/1954	MR	F1
Downings	Mary	J		Miss	00/00/1823	08/16/1895	NR	D5
Drew	Alfred	C			12/25/1859	01/18/1882	NR	F2
Drew	Jame	Andrew			02/05/1853	01/22/1917	MR	E2
Drew	Pauline	Hogan			03/29/1853	11/16/1917	MR	E2
Drew	Rebecca				00/00/0000	10/07/1890	NR	F2
Drew	Thomas	G			12/28/1810	01/07/1886	NR	F2
Dudley	Ann				06/01/1783	04/08/1852	MR	B7



## E - F Last Name

Last Name	First Name	Middle/Initial	Other Mid Name	Other Title	Birth Date	Death Date	Quad Loc	Loc
Eagles	Mary	Louise	Cox		01/01/1821	07/05/1822	BM	E7
Eagles	Oliva	Cox			04/05/1824	09/26/1840	BM	D8
Elizabeth	Laminnie				03/30/1834	10/15/1908	BM	A8
Elwood	Earl	L			00/00/1934	00/00/1991	BM	F3
Elwood	Linder	H			00/00/1931	00/00/0000	BM	F3
Enoch	Bunker				03/23/1830	01/31/1922	BM	A8
Eriksen	Esther	Dosher			10/21/1893	01/19/1990	NR	F6
Eriksen	Hakon				00/00/1891	00/00/1921	BM	B3
Eriksen	John	D			02/27/1888	01/17/1961	NR	F6
Everitt	Amelia	A			01/04/1829	11/05/1963	BN	H4
Everitt	Amelia	C			05/11/1803	01/23/1873	BN	H4
Everitt	Caroline	A			01/04/1829	10/05/1863	BN	H4
Everitt	Charles	E		Doc	07/20/1819	11/00/1852	BN	H4
Everitt	George	L			00/00/0000	00/00/0000	BN	H4
Everitt	George	W			00/00/0000	00/00/1831	BN	H4
Everitt	Marietta	G			04/24/1821	08/07/1856	BN	I4
Everitt	Sterling	B		Doc	06/06/1791	05/31/1855	BN	H4
Everitt	W.	Randolph			03/24/1827	07/24/1839	BN	H4
Ewell	Edwin	Vance			11/02/1897	10/29/1898	BN	B6
Ewell	James	Charlton			08/19/1899	08/20/1900	BN	B6
Fallow	Hester	A			00/00/0000	12/07/1900	BN	B5
Fallow	Jesse	L			00/00/0000	11/03/1868	BN	B5
Farmer	Arthur	Latney			03/31/1914	04/25/1949	BN	H4
Farmer	Robert	G			08/09/1886	10/09/1918	BN	H4
Farmer	Robert	G		Jr	06/13/1917	03/31/1919	BN	H4
Ferguson	Annie	K			07/10/1857	02/27/1938	MR	F1
Ferguson	William	R			00/00/0000	00/00/0000	MR	F1
Finch	Benjamin	Perry			09/14/1866	11/04/1928	BN	I2
Finch	Elizabeth	Annis			04/28/1872	10/25/1943	BN	I2
Fisher	Charles	Henry			12/09/1847	01/23/1910	NR	G1
Fisher	George	Warren			07/17/1894	06/16/1972	BM	C4
Fisher	J	M	C		01/01/1857	12/26/1902	BM	C4
Fisher	Miriam	Pinner			00/00/1867	00/00/1966	BM	C4
Fisher	Rebecca	Lydia	Thompson		12/19/1857	04/13/1918	NR	G1
Fisher	Thelma	C			04/13/1908	11/06/1990	BM	C4
Foley	Amanda	M			04/12/1833	06/16/1905	MR	G2
Foley	Richard	F		Mason	03/18/1836	03/03/1884	MR	G2
Ford	Grace	E			00/00/1889	00/00/1991	BN	C4
Fountain	Eliza	King			04/02/1863	11/21/1863	BN	I5
Fountain	Eunice	Earl			00/00/1894	00/00/1917	BN	G7
Fountain	Henry	Greenwood			00/00/0000	00/00/1905	BN	I5
Fountain	John	Baker			00/00/1868	00/00/1943	BN	H6
Fountain	Lena	Elizabeth			00/00/1870	00/00/1920	BN	H6
Fountain	Mary	A			01/19/1839	09/23/1893	BN	I6
Fountain	William	Baker			00/00/1896	00/00/1951	BN	I5



Last Name	First Name	Middle/Initial	Other Mid Name	Other Title	Birth Date	Death Date	Quad Loc	Loc
Fountain	William	J			02/05/1830	07/05/1892	BN	I6
Fraser	Geneva				12/22/1889	10/07/1923	NR	G5
Fraser	John	Williams			04/04/1913	04/12/1913	NR	G6
Fraser	Mary	Elizabeth			08/19/1921	11/15/1921	NR	G6
Fraser	Richard	C			00/00/1886	00/00/1922	NR	G5
Fulchar	David	West			04/08/1859	08/28/1938	BN	D4
Fulchar	Ella				00/00/1888	00/00/1889	BN	D4
Fulchar	Francis				00/00/1893	00/00/1895	BN	D4
Fulchar	Lena	B			05/11/1886	09/11/1929	BN	C6
Fulchar	Mary	Varnam			05/10/1866	04/17/1896	BN	D4
Fulchar	Mary	Woodside			11/14/1875	05/30/1930	BN	D4
Fulchar	Phillip	A			07/24/1880	07/14/1934	BN	C6
Fulchar	Sallie	L			04/20/1853	12/21/1915	BN	C6
Fulchar	Tucker	W			05/10/1851	05/25/1916	BN	C6
Fulford	Bertha	F	Arnold		09/09/1906	04/17/1996	BM	C1
Fullwood	Annie	Elizabeth			00/00/1880	00/00/1927	BN	H1
Fullwood	Ava	Lee			02/03/1936	02/03/1936	BN	H1
Fullwood	Charles	T			08/13/1876	09/22/1899	BM	E5
Fullwood	Charles	V			11/04/1844	02/24/1882	BM	E5
Fullwood	Ethel	A			05/27/1883	05/27/1883	MR	C6
Fullwood	Harry	C			12/30/1868	08/31/1892	BM	E5
Fullwood	Infant				01/27/1937	01/27/1937	BN	H1
Fullwood	Infant				03/08/1932	03/08/1932	BN	H1
Fullwood	John	W			07/06/1879	01/23/1919	MR	C5
Fullwood	Josie	Varnam			12/02/1910	03/01/1995	BN	G1
Fullwood	Lewis	Herbert			00/00/1870	00/00/1935	BN	G1
Fullwood	Lewis	Oliver			08/07/1908	08/01/1970	BN	G1
Fullwood	Martha	Spencer			00/00/1808	00/00/1831	BM	B3
Fullwood	Mary	Kathryn			00/00/1914	00/00/1939	MR	C5
Fullwood	Samuel	Porter			10/28/1852	03/28/1923	BM	B3
Fullwood	Sarah	E	Fortner		00/00/1907	00/00/1929	MR	D5
Fullwood	William	Courtland			00/00/0000	00/00/1917	NF	G6
Fullwood	William	Richmond			00/00/1907	00/00/1950	BN	G1
Furpless	Liilie	Drew			10/29/1877	12/08/1945	MR	E3
Furpless	Price				02/07/1869	11/03/1959	MR	E3



## G - Last Name

Last Name	First Name	Middle/Initial	Other Mid Name	Other Title	Birth Date	Death Date	Quad Loc	Loc
Galloway	Alfred	S			11/01/1850	01/19/1885	BN	D5
Galloway	Catherine	D			04/25/1818	04/25/1857	BN	F5
Galloway	Effie	Preston	Pinner		10/24/1864	12/13/1908	BM	C4
Galloway	Henry	B		Pfc	00/00/0000	00/00/0000	BN	F5
Galloway	Lawrence	Augusta			04/00/1857	01/00/1934	BN	E5
Galloway	Lewis	A			01/22/1816	12/24/1891	BN	E5
Galloway	Mamie	Gause			02/00/1858	02/00/1891	BN	E5
Galloway	Mary	C			12/17/1879	12/19/1879	MR	G6
Galloway	Samuel	N			05/22/1802	12/15/1854	BN	G6
Gamache	Mary			Mrs	00/00/0000	00/00/1822	BM	A8
Garrason	Emma	Perrin			03/00/1821	10/30/1877	NR	A6
Garrason	Thomas				00/00/1835	00/00/1897	NR	A6
Gaskins	Robert	Merritt			00/00/1892	00/00/1935	BM	F1
Gaskins	Sadie	Mason			00/00/1892	00/00/1957	BM	F1
Gates	Edna	Lenora			05/09/1911	06/29/1919	BM	B5
Gause	Caroline				04/09/1859	05/17/1920	NR	D6
Gause	Charles	Eyden			04/15/1875	10/01/1949	NR	D6
Gause	Ephraim	D			00/00/1825	00/00/1887	NR	D6
Gause	Gertrude	Dosher			06/01/1869	06/08/1954	NR	D6
Gause	Lucy	Estella			06/00/1853	03/00/1865	NR	D6
Gause	Rebecca	R			00/00/1836	00/00/1887	NR	D6
Gay	Ruth	Ruark			04/17/1893	03/22/1980	BN	E1
Gay	Wyatt	Delight	Gay	Vereen	03/27/1933	00/00/0000	BN	E1
Gay	Wyatt	M		Jr	08/05/1928	01/27/1995	BN	E1
Gay	Wyatt	Marion			03/02/1893	05/13/1935	BN	E1
Gilbert	Ella	J			00/00/1856	00/00/1937	BN	D5
Gilbert	Harry				00/00/0000	06/21/1895	BM	B5
Giles	Julian	Bryson			11/30/1928	00/00/0000	MR	B5
Giles	Peggy	Arnold			11/15/1930	02/04/2003	MR	B5
Gillespie	Laurence				04/01/1852	04/13/1877	MR	B3
Godwin	Charles	E.			12/09/1856	09/22/1929	BM	E2
Greer	Nancy				01/30/1843	04/03/1902	NR	C4
Gregory	George				11/06/1922	10/04/2002	BM	B1
Grimes	George	C			08/08/1873	02/13/1968	BM	F2
Grimes	Sarah	Beth			05/03/1902	12/04/1964	BM	F2
Grimes	Thomas	C			00/00/0000	11/06/1969	BM	F2
Grissom	Thomas	B			04/01/1837	04/13/1877	MR	B3
Grissom	Ann	W			01/03/1822	12/30/1889	NR	D3



Last Name	First Name	Middle/Initial	Other Mid Name	Other Title	Birth Date	Death Date	Quad Loc	Loc
Grissom	Cassandra				04/05/1846	03/10/1927	BM	F8
Grissom	E.	A.			09/27/1840	10/28/1908	BM	F8
Grissom	Infant				01/01/1903	01/01/1903	NR	F5
Grissom	Mary	Susan	S.		00/00/0000	00/00/1905	NR	F5
Gutherie	A	M			01/14/1824	08/17/1870	BM	B8
Gutherie	Elizabeth	Lord			02/11/1854	08/11/1901	BN	E6
Gutherie	Eugene	D			12/24/1876	06/01/1903	BN	E6
Gutherie	Michael	Cronly			12/14/1850	12/26/1930	BN	E6
Guthrie	Amelia	Ann			11/25/1820	12/25/1909	BM	B8
Guthrie	Catherine	Davis			12/15/1852	04/23/1920	MR	E2
Guthrie	Eliza	B			06/30/1855	12/03/1903	BM	B8
Guthrie	James	W.			01/17/1819	02/09/1872	BM	B8
Guthrie	Sarah	A			10/28/1823	09/01/1887	BM	B8
Guthrie	Viola	W.			00/00/1877	00/00/1963	BM	F6
Guy	W	E		Rev	11/18/1883	02/08/1924	BN	F3



## H - I Last Name

Last Name	First Name	Middle/Initial	Other Mid Name	Other Title	Birth Date	Death Date	Quad Loc	Loc
Hanan	Son				11/05/1943	11/05/1943	NR	A3
Hancock	Betty	Earle			08/08/1927	07/20/1929	BN	E3
Hancock	Earl				06/01/1901	11/01/1992	BN	E3
Hancock	Lois	E			01/29/1907	05/11/1954	BN	E3
Hansley	Francis	Guthrie			02/09/1852	12/15/1932	BM	B8
Hardee	Irene	N			04/22/1932	03/07/1995	BN	E1
Harker	Carrie	Amanda			09/23/1906	12/21/1994	NR	G6
Harker	John				11/12/1872	12/31/1931	NR	G5
Harker	Stella	G			08/30/1880	06/21/1919	NR	G6
Harper	Annie	S			01/20/1844	04/19/1913	MR	A6
Harper	James	Madison			08/03/1911	04/15/1994	BM	A8
Harper	James	Thomas			09/04/1843	03/09/1915	MR	A6
Harper	Margearet	Taylor			02/17/1917	10/11/2009	BM	A8
Harper	Robbie				06/30/1876	01/12/1877	MR	A6
Harris	James	Clay			03/19/1904	02/16/1976	BN	C4
Harris	Margaret	Farmer			10/17/1915	04/23/1997	BN	C4
Hartwig	Geraldine	Wesley			12/11/1926	12/10/2004	BN	A4
Hartwig	Harold	Edward			06/04/1924	09/10/1988	BN	A4
Haskett	Carrie			Mrs	12/06/1851	07/12/1928	NR	G5
Haskett	James	P			05/01/1875	06/10/1918	NR	G6
Haskett	Louise				10/27/1877	02/15/1923	NR	G6
Haskett	W.	Ben			10/13/1890	06/28/1920	NR	G6
Haskett	William	T			10/17/1848	10/29/1915	NR	G5
Heckman	Jane	Brown			00/00/1827	06/05/1851	MR	F5
Hewett	Charles	S			12/31/1863	03/01/1941	BM	C5
Hewett	Johnnie	G			01/18/1903	11/04/1983	BN	G1
Hewett	Lettie	M			09/25/1875	07/14/1962	BM	C5
Hewett	Mary	Cox			10/17/1909	05/07/1963	BN	F1
Hewett	Mary	E			06/29/1927	01/14/1934	BN	H1
Hickman	Clayton				11/29/1902	04/26/1986	BN	F4
Hickman	Mary	E			00/00/1849	00/00/1921	BN	F4
Hickman	Peter	G.			08/07/1892	01/12/1958	BN	F4
Hickman	W.	N.			03/30/1873	02/16/1909	BN	F4
Hicks	David			Jr	05/07/1774	03/16/1804	MR	D6
Hirsch	Zerline				06/30/1855	03/15/1856	MR	A5
Holden	Abbie	Lewis			11/11/1886	07/10/1966	NR	D2
Holden	Clarence				06/23/1873	03/29/1946	NR	D2
Holden	Robert	W			06/26/1893	12/29/1968	BN	C6
Holden	Robert	W.		Jr	10/18/1916	05/13/1918	BN	G4
Holden	William	Campbell			02/05/1921	05/03/1997	BN	G3
Holden	Alma				07/22/1905	03/30/1910	NR	D2
Hood	Amanda				02/10/1890	11/22/1890	MR	G2
Hood	H	Warren		Jr	05/24/1892	12/29/1952	MR	G2
Hood	Infant				00/00/0000	00/00/0000	MR	G2
Hood	Kate	F			05/12/1867	08/03/1928	MR	G2
Hood	Martha	R			12/18/1839	09/07/1908	BM	E7
Hood	Ruth	R			01/01/1908	12/28/1979	MR	G2
Hood	Winnie	Willis			03/28/1902	10/22/1958	BM	E1
Hood	H	Warren			10/11/1861	06/04/1915	MR	G2



Last Name	First Name	Middle/Initial	Other Mid Name	Other Title	Birth Date	Death Date	Quad Loc	Loc
Hooker	S				10/08/1826	10/08/1879	MR	F3
Howe	Robert				00/00/1732	00/00/1786	MR	B1
Howe	Sarah	Grange			00/00/1740	00/00/1792	MR	B1
Howey	George	Parker			00/00/1863	00/00/1929	BN	F5
Howey	Harriet	Legge			00/00/1873	00/00/1943	BN	F5
Howey	Mary	Dickson			00/00/1849	00/00/1933	BN	F5
Huntley	Eunice	F	Daniel		10/03/1909	04/18/1996	NR	C1
Hutchinson	James	E			01/19/1876	02/25/1917	MR	B4
Infant								
Unknown					00/00/0000	00/00/0000	BN	H6
Infant								
Unknown					00/00/0000	00/00/0000	BN	H6



## J - K - L Last Name

Last Name	First Name	Middle/Initial	Other Mid Name	Other Title	Birth Date	Death Date	Quad Loc	Loc
Jannette	Muriel	Thompson			00/00/1908	00/00/1935	BM	B4
Jelks	Joseph	W			10/27/1871	02/01/1933	NR	E3
Jelks	Josie	Jelks	Powledge		06/22/1895	06/21/1988	NR	E3
Johnson	Alfred				00/00/0000	07/25/1911	BM	B4
Johnson	Oliva	A.		Miss	04/01/1883	10/20/1905	NR	E1
Jones	Alice	Rebecca	Woodside		00/00/1870	00/00/1920	NR	G4
Jones	George	Hugh			09/16/1926	02/13/1977	BN	F1
Jones	James	D			10/10/1923	07/04/1933	BN	F1
Jones	John	J		Jr	09/14/1922	12/29/1929	BN	F1
Jones	John	J			00/00/1866	00/00/1914	NR	G4
Jones	John	Jay			02/10/1895	11/24/1963	BN	F1
Jones	Lila	Burr			03/27/1902	09/21/1975	BN	G1
Jones	Mary	Elizabeth			08/17/1928	02/12/1946	BN	F1
Jorgensen	Emma	G.			05/29/1886	12/09/1960	BM	D3
Jorgensen	Neils				00/00/1868	03/06/1920	BM	D3
Jorgensen	Robert	M.			02/11/1917	06/09/1938	BM	D3
Judge	William	J			09/18/1880	02/10/1899	MR	G3
Keal	Adeline	Burriss			04/07/1856	02/22/1923	NR	E5
Keal	Audra	H			02/26/1880	08/12/1886	NR	D5
Keal	Isola	W			02/18/1881	08/23/1897	NR	D5
Keal	John	W			07/25/1882	07/09/1904	NR	E5
Keal	John	W		Sr	10/20/1849	03/10/1910	NR	E5
Keal	Lula				10/22/1878	09/27/1879	NR	D5
Kiddoo	Raymond	James			07/18/1911	01/30/1987	BM	A7
King	Phillip			Jr	00/00/1908	00/00/1988	MR	C4
King	Susan	Mame			00/00/1915	00/00/1990	MR	C4
Kirby	Robert	Galloway			00/00/0000	00/00/0000	BN	C6
Kirby	Sarah	P			06/13/1840	01/13/1911	BN	C6
Kissenger	Bertha	Lee			05/18/1884	05/12/1906	NR	D3
Kopp	Albert	Henry			05/06/1869	07/28/1905	MR	A1
Lake	Thomas				00/00/0000	12/22/1907	MR	F2
Langdon	Richard			Jr	07/01/1825	12/01/1826	BM	A8
Langdon	Richard				03/18/1793	01/19/1847	BM	B8
Larkins	Dora	Bellamy			11/04/1900	08/23/1901	NR	A2
Larsen	Charles	Bervin			00/00/1931	00/00/1931	BM	C3
Larsen	Lue				00/00/1882	00/00/1964	BM	C3
Larsen	Peter				00/00/1871	00/00/1921	BM	C3
Legg	J.	N.			00/00/1821	02/04/1896	MR	F1
Legg	Susan				01/08/1823	09/13/1889	MR	F1
Legge	Catherine	Lydia			03/27/1871	04/11/1902	BN	E4
Legge	Charles	H			03/23/1833	05/06/1896	BN	E4
Legge	Eleanor	E	Galloway		12/24/1842	02/18/1915	BN	E4
Legge	Mary	Barton			10/13/1883	01/20/1919	BN	E4
Leggett	Percy	Ormond			02/20/1877	09/15/1935	BM	A6
Leggett	Percy	Ormond		Jr	00/00/1916	00/00/1977	MR	E3
Leggett	Vienna	Mae	O'Quinn		05/01/1891	09/29/1964	BM	A6
Lehew	Eliza				00/00/0000	08/09/1874	BN	F5
Lehew	Benjamin	F.			00/00/1863	00/00/1950	NR	C6
Lehew	Emma	Greer			00/00/1870	00/00/1924	NR	C6
Lehew	Mary	B			12/10/1848	06/30/1889	NR	F6



Last Name	First Name	Middle/Initial	Other Mid Name	Other Title	Birth Date	Death Date	Quad Loc	Loc
Lehew	Samuel	Wm			00/00/1834	00/00/1906	NR	C6
Leinart	Lella	Cox			05/05/1894	09/03/1978	BM	C5
Leinart	Wayne	C			12/08/1880	09/28/1959	BM	C5
Leonard	Alice	J			04/22/1853	05/06/1910	NR	B5
Leonard	T	L			00/00/0000	00/00/0000	NR	B5
Leonard	T	L			12/31/1875	07/25/1937	NR	B5
Leonard	W	F			07/06/1877	08/21/1924	NR	B5
Leonard	W.	L			00/00/0000	00/00/0000	NR	B5
Lewis	Charles	M			00/00/1840	00/00/1925	NR	B6
Lewis	Elizabeth	Ann			11/08/1856	08/13/1894	NR	B6
Lewis	Family	Members			00/00/0000	00/00/0000	BN	D7
Lewis	Jacob	A.			04/09/1856	03/12/1935	NR	E1
Lewis	Kate	Stuart			10/14/1903	10/01/1904	MR	E4
Lewis	Mary	W			00/00/1864	00/00/1953	BN	A7
Lewis	Melvin			Sr	00/00/1860	00/00/1939	BN	A7
Lewis	Penelope	J			03/04/1854	10/09/1934	NR	E1
Lewis	Robert	B			08/10/1860	12/25/1920	BN	D7
Lewis	Virginia	C	Holden		12/14/1862	10/18/1942	BN	D7
Lewis	William	R			12/03/1848	11/20/1926	NR	B6
Lind	Alex	L			06/22/1872	10/29/1964	BN	B5
Lind	Emma	B			11/08/1879	10/28/1968	BN	B5
Long	Henry				01/01/1774	10/18/1816	BM	D8
Longest	Annie	Hatridge B.	Potter		09/09/1831	11/30/1881	MR	E4
Lund	Helena				11/24/1884	07/16/1923	BM	F3
Lund	Kjeld				06/17/1872	11/08/1921	BM	F3



## M Last Name

Last Name	First Name	Middle/Initial	Other Mid Name	Other Title	Birth Date	Death Date	Quad Loc	Loc
Manson	David	W			03/09/1847	07/09/1920	MR	E4
Manson	Ida	C			03/09/1858	04/04/1920	MR	E4
Manson	Our	Little	Nellie		06/02/1831	07/05/1872	MR	E4
Marren	Mabel	Price			05/10/1873	03/19/1948	BN	A4
Mathews	B.	B.			00/00/0000	00/00/0000	BN	I6
Mathews	Margaret	T			08/02/1820	08/22/1853	BN	I6
Matthews	Jarrott				03/12/1812	11/13/1898	MR	B5
Mayer	Aunt Lizzie	Lizzie			11/22/1854	03/03/1932	BM	E5
McCowen	Rosemary	W			00/00/1948	00/00/1987	BM	C8
McCreary	Anna	A			07/05/1865	02/05/1863	NR	B6
McCreary	Mary	A			01/01/1835	02/09/1863	NR	B6
McGrath	John	Raphael	Gordon		00/00/0000	10/00/1934	BN	H3
McKeithan	A	Tilden			10/20/1876	01/19/1935	BN	D4
McKeithan	Charles	E.			06/27/1875	08/15/1899	BM	E4
McKeithan	Christopher	C			01/15/1871	07/22/1926	NR	E1
McKeithan	Daughter				04/09/1906	04/22/1906	NR	E1
McKeithan	Elizabeth	Piggott			10/18/1889	03/07/1962	BN	D4
McKeithan	Hannah				05/18/1831	07/12/1914	BM	C5
McKeithan	Ida	C			09/27/1876	03/00/1888	BM	E4
McKeithan	James	K			08/24/1921	06/13/1972	BN	D4
McKeithan	John	W			01/22/1869	12/29/1936	BM	B6
McKeithan	Katherine	T			08/26/1869	07/08/1942	BM	B6
McKeithan	M.	J.			01/31/1846	08/16/1911	BM	E4
McKeithan	Moses	A.			02/04/1841	05/12/1928	BM	E4
McKeithan	Pauline	Hughes			05/01/1882	07/22/1956	NR	E1
McKeithan	Phillip	T			12/20/1893	04/11/1969	BM	B6
McKeithan	Theodora				06/12/1825	05/13/1910	BM	C5
McNeil	Gertrude	Gause			09/16/1905	04/04/1977	NR	D6
McNeil	James	Agustine			08/28/1898	10/29/1978	NR	D6
McRackan	Annie	Lucille			12/15/1894	01/27/1977	BN	H2
McRackan	Annie	Neal	Thomson		07/30/1869	10/14/1934	BN	H1
McRackan	John	Robert		Sr	03/15/1866	04/10/1927	BN	H1
McRackan	John	Robert		Jr	07/07/1901	01/14/1964	BN	H1
McRackan	Margaret	Graig			04/02/1930	04/02/1930	BN	H1
McRackan	Neal			Jr	08/06/1912	10/24/1902	BN	I2
McRackan	Sophia	A			10/23/1841	07/09/1888	NR	E6
McRackan	William	W.			03/20/1836	10/05/1919	NR	F6
Mellen	Albert	H			00/00/1854	09/21/1876	BM	G8
Messick	Gilbert	Kendell			00/00/0000	10/21/1940	NR	F6
Messick	Mary	Parker			05/23/1890	02/20/1941	NR	F6
Messick	Sophia	McRackan			07/10/1894	03/04/1899	BN	H1
Mintz	Glenda	A			06/23/1933	08/14/1997	BN	E2
Moore	Billie	B.			03/28/1928	04/19/1933	BM	D3
Moore	Dorothy	G.			04/29/1919	09/18/1921	BM	D3
Moore	John				03/15/1852	03/22/1920	NR	D4
Moore	Sallie	R			12/26/1860	01/07/1936	NR	F6
Moore	Sophia			Mrs	00/00/1827	11/14/1887	NR	D4



Last Name	First Name	Middle/Initial	Other Mid Name	Other Title	Birth Date	Death Date	Quad Loc	Loc
Moore	Virginia	C			11/11/1845	03/22/1905	NR	D4
Moore	W	A			09/09/1853	06/26/1914	NR	F6
Moore	Walburg	Fisher			01/21/1900	05/09/1969	BM	C4
Moore	William	Benjamin			09/05/1893	12/11/1935	BM	C4
Morgan	Gussie				09/20/1898	10/08/1902	BN	A6
Morse	Ada	F			12/30/1875	02/05/1955	MR	G2
Morse	Bryan				03/22/1850	01/28/1886	NR	E4
Morse	Christopher	G			06/09/1829	11/21/1903	MR	F2
Morse	Joseph	C.			08/12/1880	12/11/1914	BM	C8
Morse	M	Virginia			04/23/1832	12/01/1903	MR	F2
Morse	Robert	B			12/01/1868	06/21/1937	MR	F2



## N - O Last Name

Last Name	First Name	Middle/Initial	Other Mid Name	Other Title	Birth Date	Death Date	Quad Loc	Loc
Newton	Addie	Dosher			05/18/1897	06/05/1900	NR	B2
Newton	Albert	A			06/20/1872	09/28/1879	NR	B3
Newton	Alease	C			06/15/1903	06/07/1999	NR	B2
Newton	Alfred	P			01/01/1907	09/17/1946	NR	C3
Newton	Allie	D			09/11/1865	11/12/1922	NR	B3
Newton	Ann	Lou	Knox		04/14/1900	06/19/1985	BM	A6
Newton	Annie	B			06/22/1894	12/27/1900	NR	B2
Newton	Annie	Louise	St.George		09/15/1892	05/03/1978	NR	F6
Newton	Annie	M			08/28/1857	09/01/1937	NR	B2
Newton	Annie	M			09/07/1881	04/21/1959	NR	B3
Newton	Annis				00/00/1882	00/00/1883	NR	B2
Newton	Arthur	Edmond			08/31/1922	07/16/1964	BN	H3
Newton	Barbara	Neal			05/01/1935	02/18/2005	BM	A6
Newton	Barbara	Neal			05/01/1938	06/03/2007	BM	A8
Newton	Benjamin	F			04/27/1863	10/21/1929	NR	B2
Newton	Blanche	Alva			08/09/1888	12/10/1940	NR	C3
Newton	Calender				05/05/1857?	10/22/1888	NR	B3
Newton	Caroline				01/06/1922	07/18/1923	NR	B2
Newton	Clyde				06/01/1884	07/28/1964	NR	B2
Newton	Dallas	F			05/20/1898	10/23/1898	NR	B2
Newton	Daughter				11/09/1897	06/07/1903	NR	B2
Newton	David	Carlton			03/13/1917	07/04/1919	BN	H3
Newton	Edward	Cranmer			04/04/1890	03/05/1968	BM	A6
Newton	Florence	Eloise			09/02/1894	06/20/1900	NR	B2
Newton	Gene				00/00/0000	00/00/1962	NR	C3
Newton	Ida	F			11/08/1890	12/06/1936	BN	H3
Newton	James	Sokes			02/11/1805?	02/11/1883	NR	B3
Newton	John	R			03/25/1886	12/06/1936	BN	H3
Newton	John	Richard			06/04/1932	00/00/0000	BM	A6
Newton	John	Richard			06/09/1849	03/20/1928	NR	B2
Newton	John	Richard			04/18/1876	10/04/1942	NR	C3
Newton	Josphine	Bensell			07/15/1851	03/26/1939	NR	B2
Newton	Margaret	Payton			05/23/1890	08/23/1906	NR	B2
Newton	Mary				10/04/1800?	10/07/1888	NR	B2
Newton	Mary	H			12/29/1884	07/28/1927	NR	B2
Newton	Mary	H			07/12/1871	08/24/1935	NR	C4
Newton	Samuel	D			06/04/1864	08/09/1935	NR	C4
Newton	Samuel	Pinner			12/29/1935	11/13/2008	BN	E1
Newton	Star	Yvonne			03/23/1956	02/10/1961	BN	H3
Newton	Susan	A			09/09/1830?	09/09/1883	NR	B3
Newton	Susan	Curtis			10/14/1878	06/26/1958	NR	C3
Newton	Susan	E			00/00/1825	11/30/1912	BM	E5
Newton	Unknown1	JHN-footstone			00/00/0000	00/00/0000	NR	B2
Newton	Unknown2	ALN-footstone			00/00/0000	00/00/0000	NR	B2
Newton	W	D			11/09/1897	06/07/1903	NR	B2
Newton	Walker				01/28/1855	08/23/1930	NR	B2



Last Name	First Name	Middle/Initial	Other Mid Name	Other Title	Birth Date	Death Date	Quad Loc	Loc
Newton	Weisner				11/16/1895	06/24/1936	NR	B2
Newton	William	J			09/21/1915	05/11/1996	NR	B3
Newton	William	Julius			12/15/1852	03/28/1921	NR	B2
Northrop	Lucy	B			00/00/1869	00/00/0000	BN	A7
Northrop	Lucy	N			00/00/0000	00/00/0000	BN	A7
Northrop	Sam	B			00/00/1868	00/00/1930	BN	A7
Oliver	Bertha	Lay			08/14/1900	07/11/1973	MR	C5
Oliver	Edward	Lee			02/28/1895	02/10/1988	MR	D5
Omirly	Agatha	Gaskins			04/08/1910	03/31/1983	BM	F1
O'Neal	George				04/17/1889	07/03/1939	BM	E2
O'Quinn	Cora	Emma			01/05/1871	02/09/1921	BM	A6
O'Quinn	Ortho	Orwood			06/15/1892	11/11/1899	BM	A6
O'Quinn	W	C			09/13/1866	04/13/1919	BM	A6
Ottaway	Sarah	J.			01/06/1860	03/15/1917	NR	F3
Ottaway	W.	T.			09/29/1860	12/24/1927	NR	F3



## P Last Name

Last Name	First Name	Middle/Initial	Other Mid Name	Other Title	Birth Date	Death Date	Quad Loc	Loc
Parker	Annie	Dosher			02/03/1867	11/05/1948	NR	F6
Parker	N.	F.			02/17/1854	10/25/1909	NR	F6
Payne	Carrie				11/08/1892	07/15/1907	BM	C5
Payne	Lizze				02/12/1883	11/09/1898	BM	C5
Peadrick	Alice	K			04/14/1897	12/25/1901	BN	B6
Peadrick	Virginia	Pridgen			06/11/1855	06/10/1927	BN	B6
Pearce	Henry				00/00/0000	00/00/0000	MR	D2
Pearce	James	Monroe			12/22/1852	06/12/1895	MR	D2
Pearce	Mary	J			00/00/0000	00/00/0000	MR	D2
Pearce	Mary	Taylor			04/13/1858	01/19/1939	MR	D2
Pepper	Lillie	A			09/04/1855	10/28/1890	MR	E4
Pepper	Louis	James			01/17/1850	04/09/1919	MR	E4
Pepper	Olympus	Victoria	Vernon		11/06/1862	07/18/1941	MR	F5
Perry	Travis				08/23/1925	02/21/1927	BN	G5
Phelps	Harry				00/00/0000	00/00/0000	NR	G1
Phelps	Henry	Earl			07/24/1864	12/31/1910	BN	A6
Phelps	May				00/00/0000	03/01/1970	NR	G1
Phelps	Serelia	Annie			04/27/1866	04/24/1953	BN	A6
Piner	C.	C.			04/01/1851	04/13/1877	MR	B3
Pinner	Anna	C			01/08/1853	04/08/1873	BM	B8
Pinner	Betty	Newton			05/24/1931	06/06/1934	BM	D4
Pinner	Dula	R			00/00/1900	00/00/1992	BN	D1
Pinner	Elizabeth	Newton			04/14/1866	09/07/1930	BM	D3
Pinner	James	A			05/19/1863	12/18/1952	BM	D3
Pinner	James	E			04/10/1899	07/01/1981	BN	D1
Pinner	Jerry	Newton			06/16/1937	06/24/1938	BM	D3
Pinner	Mary	Taylor	Sattes		03/17/1899	08/05/1911	BM	D3
Pinner	O	C			09/14/1886	03/16/1911	BN	H5
Pinner	Reginald	A.			11/30/1903	08/11/1947	BM	D4
Pinner	Virginia	Catherine			12/18/1859	04/22/1908	BN	H5
Piver	George	H			00/00/1861	00/00/1917	BN	C4
Piver	Lillie	Drew			06/22/1904	07/30/1909	BN	C4
Piver	Little	Mama			09/04/1869	07/30/1870	BN	G6
Piver	Minnie	Ida			04/15/1887	10/11/1901	BN	C4
Piver	Minnie	K			00/00/1861	00/00/1949	BN	C4
Placey	Winnie	L			00/00/0000	10/14/1929	BM	C6
PlainMarker					00/00/0000	00/00/0000	MR	F1
PlainMarker					00/00/0000	00/00/0000	MR	F1
PlainMarker					00/00/0000	00/00/0000	MR	F1
PlainMarker					00/00/0000	00/00/0000	MR	F1
PlainMarker					00/00/0000	00/00/0000	NR	D4
PlainMarker					00/00/0000	00/00/0000	NR	F2
PlainMarker					00/00/0000	00/00/0000	NR	F2
PlainMarker					00/00/0000	00/00/0000	NR	F2
PlainMarker					00/00/0000	00/00/0000	NR	G2
PlainMarker					00/00/0000	00/00/0000	MR	E3
Platt	Henry	L			01/01/1843	01/31/1891	NR	F3
Platt	Thomas	W			12/02/1879	11/07/1882	NR	F3
Potter	Ann				09/09/1795	09/09/1815	BN	H3



Last Name	First Name	Middle/Initial	Other Mid Name	Other Title	Birth Date	Death Date	Quad Loc	Loc
Potter	Elizabeth				02/09/1867	01/08/1940	BM	E3
Potter	Mary	Susan			12/11/1869	07/11/1913	BM	F8
Potter	Matilda				00/00/0000	00/00/0000	BN	H3
Potter	Milton				00/00/0000	00/00/0000	BN	H3
Potter	Mitchell	G			00/00/0000	00/00/0000	BM	E8
Potter	Nathaniel				01/01/1783	11/03/1851	MR	E4
Potter	Rachel	Jane			07/17/1779	07/21/1836	BN	H3
Potter	Rebecca				01/01/1777	01/04/1842	BM	E8
Potter	Sallie	A			11/14/1839	11/30/1881	MR	E4
Potter	Samuel				05/29/1780	05/29/1847	BN	H3
Potter	Samuel				00/00/0000	00/00/0000	BN	H3
Potter	Sarah	J			01/01/1800	00/00/1834	MR	E4
Potter	William	Julius			02/09/1836	11/17/1895	MR	E4
Price	Ann				00/00/1776	06/17/1858	NR	A6
Price	Carey	L			10/30/1892	09/19/1893	BM	B8
Price	Caroline				00/00/1832	04/19/1879	NR	A6
Price	Eliza	T			00/00/1806	06/09/1872	NR	A6
Price	Elizabeth	A			00/00/1867	00/00/1954	BM	B8
Price	Emaline	Tharp			02/15/1841	10/01/1890	BN	G6
	Infant							
Price	Daughter				00/00/0000	00/00/0000	BM	B8
Price	James				00/00/1802	11/22/1837	NR	A6
Price	Jesse	D			00/00/1867	00/00/1948	BM	B8
Price	John	B			00/00/1793	09/02/1862	NR	A6
Price	John	E			00/00/1848	00/00/1924	BN	B5
Price	John	L			06/13/1877	07/20/1937	BN	B5
Price	Mary				00/00/0000	00/00/0000	NR	A6
Price	Mary	Elizabeth			07/24/1832	11/00/1904	BN	G6
Price	Mary	Farlow			00/00/1848	00/00/1937	BN	B5
Price	Mary	A			03/00/1821	10/10/1880	NR	A6
Price	Mary	Elizabeth			00/00/1832	01/20/1904	BN	G6
Price	Mary	Jane			00/00/0000	01/20/1855	BN	G6
Price	Richie				00/00/0000	00/00/0000	NR	A6
Price	Samuel	B			12/11/1811	05/22/1897	BN	G7
Price	Sarah	E.			12/31/1823	12/31/1895	BN	G7
Price	Sarah	Florence			06/21/1863	04/21/1929	BN	G7
Prioleau	Caroline	Marie			00/00/0000	10/00/1862	BM	G8
Prioleau	John	Brown			00/00/1851	10/00/1862	BM	G8
Prioleau	Thomas	G			00/00/1849	10/00/1862	BM	G8



## R Last Name

Last Name	First Name	Middle/Initial	Other Mid Name	Other Title	Birth Date	Death Date	Quad Loc	Loc
Raby	Jane	Martini			08/21/1915	02/03/1987	NR	G2
Rankin	Margrette	Aldridge			00/00/1910	00/00/1987	BN	G1
Rankin	Salem	Dickson			04/06/1919	10/30/1992	BN	G1
Rees	J	Louise			06/23/1922	10/29/1958	BN	E5
Rees	Rebecca	Fullwood			12/18/1884	03/10/1968	BN	E5
Reiger	Augustine	W			00/00/1848	00/00/1903	NR	G2
Reiger	Florence	Medway			00/00/1882	00/00/1977	NR	G2
Reiger	Sarah	Thompson			12/19/1855	00/00/1937	NR	G2
Richards	Lula	D			02/20/1865	05/03/1900	MR	D5
Robbins	Annie	Livingson			07/01/1881	09/22/1882	NR	A2
Robbins	Eliza				09/03/1833	09/29/1889	NR	A2
Robbins	Infant				09/22/1887	09/22/1887	NR	A2
Robbins	Lina	W			10/07/1861	08/22/1912	NR	A2
Robbins	Lina	Williams			10/07/1893	10/08/1893	NR	A2
Robbins	Robert	Springfield			03/24/1880	06/04/1880	NR	A2
Robbins	S.	M.			07/05/1834	07/21/1917	NR	A2
Robbins	Son				01/06/1891	01/18/1896	NR	A2
Robbins	T	Lorena			02/01/1873	07/15/1881	NR	A2
Rogers	Mary	A			00/00/1890	00/00/1934	BM	E1
Rook	Mary	Rachel	Corlette		10/21/1902	01/01/1996	BN	D3
Ruark	A.	Dosher			06/02/1890	10/29/1955	BM	E4
Ruark	Agnes	K			08/10/1882	09/29/1883	NR	B1
Ruark	Alice	D			00/00/1900	00/00/1901	NR	B1
Ruark	Beulah	Stiffer			00/00/1897	00/00/1985	NR	B1
Ruark	Bryant	Whitfield			00/00/1892	00/00/1984	NR	B1
Ruark	Catherine				00/00/0000	00/00/0000	MR	G2
Ruark	Cronly	G			00/00/1888	00/00/1954	NR	B1
Ruark	Edith				05/08/1884	08/12/1884	NR	B1
Ruark	Elizabeth				00/00/1844	02/08/1895	BM	F7
Ruark	Estelle	P.			11/24/1893	08/24/1970	BM	E4
Ruark	Eva	A			00/00/1889	00/00/0000	NR	B1
Ruark	George	H			05/17/1884	11/17/1933	BN	F1
Ruark	Grace	P			00/00/1903	00/00/1980	NR	B1
Ruark	James				06/25/1881	07/03/1881	NR	B1
Ruark	James	B			00/00/1857	00/00/1934	NR	B1
Ruark	Joseph	W			11/29/1885	06/29/1950	NR	B1
Ruark	Julia	Dosher			00/00/1851	00/00/1879	NR	A2
Ruark	Lou	Ella			04/25/1882	01/23/1955	BN	F1
Ruark	Marjorie				08/06/1898	10/27/1899	NR	B1
Ruark	Sallie	P			10/31/1896	05/15/1897	NR	B1
Ruark	Sarah	P			00/00/1867	00/00/1939	NR	B1



Last Name	First Name	Middle/Initial	Other Mid Name	Other Title	Birth Date	Death Date	Quad Loc	Loc
Ruark	Wilson	Wade			00/00/1854	00/00/1941	NR	A2
Russ	Mary	Rees			05/16/1908	11/05/1996	BN	F3
Russ	Sempronius	Jane			11/17/1765	11/19/1816	BM	E8
Russ	William	Albert		Jr	01/12/1908	01/03/1992	BN	F3



## S Last Name

Last Name	First Name	Middle/Initial	Other Mid Name	Other Title	Birth Date	Death Date	Quad Loc	Loc
Savage	George	Thomas		Sr	00/00/1915	00/00/1971	BN	D1
Savage	Kathryn	Ruark			00/00/1915	00/00/1993	BN	D1
Scales	Peter				00/00/0000	02/12/1817	MR	B5
Schulze	Henry	W			11/05/1914	07/18/1993	BM	F3
Scribner	Emma	W			12/18/1871	10/17/1912	BN	D6
Sellers	John	S			06/22/1860	04/03/1923	BN	H6
Sellers	Little	Buddie			12/26/1887	06/07/1888	BN	I6
Sellers	Mary	Ceicel			12/26/1887	09/12/1888	BN	I6
Sellers	Sallie	M			02/26/1859	11/30/1948	BN	H6
Sellers	Celia				10/19/1839	12/01/1870	BN	G6
Sellers	Eliza				11/16/1832	09/05/1887	BN	G6
Sellers	James	R			04/01/1851	12/11/1872	MR	B3
Sellers	Luella	A			12/21/1871	10/17/1873	MR	A3
Sellers	Susan	Furpless			01/27/1846	06/28/1911	MR	F1
Sellers	Victor	Dyson			05/26/1928	06/15/1934	BM	A3
Sellers	William	Thomas			07/26/1870	08/14/1871	BN	G6
Sherrill	Homer	Woodrow			03/14/1916	04/20/1990	BM	B3
Sherrill	Margarete	L			04/07/1920	10/16/2000	BM	B3
Singletary	Charlotte				07/29/1912	07/29/1912	MR	D3
Singletary	George	E			11/11/1877	01/12/1953	MR	D3
Singletary	Joseph	P			02/16/1868	11/12/1926	MR	D3
Skerritt	Joseph	H			00/00/0000	09/06/1829	BN	G6
Small	Alice	E			00/00/1896	00/00/1954	NR	F6
Small	Fred	A			00/00/1881	00/00/1965	NR	F6
Smith	Ann				11/26/1815	09/13/1878	NR	A1
Smith	Benjamin				01/10/1756	01/10/1826	MR	B1
Smith	Cora	Arabell			06/20/1852	02/04/1858	BN	E6
Smith	Cornelius				00/00/1838	00/00/1898	NR	A1
Smith	Emma	Julia	Galloway		06/25/1839	12/16/1915	BN	F5
Smith	Fannie	McKeithan			00/00/1840	00/00/1905	NR	A1
Smith	Harold	B			04/17/1891	02/06/1965	NR	C3
Smith	J.	C.	Baker		01/12/1842	12/09/1847	NR	A1
Smith	John			Mason	10/20/1793	10/20/1858	BN	E6
Smith	Josphine	Newton			06/29/1896	12/20/1988	NR	C3
Smith	M	Thomas		Mr	12/11/1776	10/14/1830	BN	H6
Smith	Percy	Cameron			01/10/1923	04/21/1923	BN	E3
Smith	Sarah	Dry			00/00/1762	00/00/1821	MR	B1
Smith	Thomas				00/00/0000	00/00/1830	BN	H6
Smith	Amelia	C			00/00/1834	04/04/1855	NR	A6
Smith	George	R			00/00/1831	07/10/1856	NR	A6
Snell	Nellie	M			02/27/1880	10/16/1881	NR	G2
Southerland	Charles				08/28/1911	08/27/1998	BN	F3
Southerland	Charles	E			09/30/1861	02/03/1923	BN	F3
Southerland	Elizabeth	Hickman			05/14/1871	02/01/1954	BN	C5
Southerland	Hiram	Williams			09/12/1864	06/05/1930	BN	C5
Southerland	Jerry	Glen			12/17/1904	09/05/1906	BN	C5
Southerland	Julia	E			02/26/1905	02/26/1906	BN	C5
Southerland	Laney	H			02/01/1881	02/17/1972	BN	F3
Spencer	Eliza	C			08/13/1863	04/04/1893	NR	A2
Spencer	Elmer				12/13/1891	01/19/1892	NR	A2



Last Name	First Name	Middle/Initial	Other Mid Name	Other Title	Birth Date	Death Date	Quad Loc	Loc
Spencer	Infant				12/13/1893	03/28/1893	NR	A2
St. George	Ada	Dosher			00/00/1867	00/00/1929	NR	E4
St. George	Almeta				07/18/1892	12/21/1915	NR	G4
St. George	Charles	B			07/01/1866	09/11/1931	NR	F6
St. George	Charlie	Hallet			02/07/1894	10/18/1910	NR	A3
St. George	Donald	F			09/30/1896	08/08/1972	NR	F6
St. George	Dula	Weeks			09/21/1882	03/14/1882	BN	H6
St. George	Elster	Wade			00/00/1896	00/00/1984	BM	F4
St. George	Florence	Daniels			01/08/1869	12/31/1931	NR	F6
St. George	Isabel	W			00/00/1860	00/00/1934	NR	A3
St. George	John	Newton			00/00/1858	00/00/1928	BN	D6
St. George	Lousia	Smith	Dosher		10/10/1833	02/21/1900	NR	A3
St. George	Marion	Perry			04/25/1896	12/24/1985	NR	E4
St. George	Mary	Ruark			06/08/1893	04/09/1960	NR	B1
St. George	Nathalia	Daniels			00/00/1853	00/00/1946	BN	D6
St. George	R	C			00/00/1892	00/00/1948	NR	B1
St. George	Richard	D			04/05/1890	06/15/1863	BN	H6
St. George	Rivers				11/17/1886	12/06/1919	NR	A3
St. George	Robert				04/01/1850	12/11/1872	MR	B3
St. George	Thomas				00/00/1868	00/00/1939	NR	E4
St. George	William				00/00/1855	00/00/1924	NR	A3
St. George	William	F			02/26/1905	08/20/1905	NR	A3
St. George	William	T			07/15/1887	04/16/1901	BN	D6
Standland	Elizabeth	V			01/29/1852	11/25/1935	NR	G4
Standland	Lola	May			11/22/1875	04/11/1926	NR	G4
Standland	Samuel	H			02/04/1872	10/27/1938	NR	G4
Stanolano	Lorenza				03/28/1848	09/22/1886	NR	G4
Stevens	Alfred	Enoch			12/04/1860	03/13/1953	BM	A8
Stevens	Charles	Larminie			12/17/1857	03/04/1937	BM	A8
Stevens	William	Harold			02/24/1916	08/11/1955	BM	F3
Stewart	Wm				10/02/1812	10/02/1867	MR	F3
Stokbak	Margaret	Lung			08/30/1907	02/16/2001	BM	F3
Stone	Hattie	Ruark			12/29/1876	05/17/1966	NR	B1
Stone	Infant				00/00/0000	00/00/0000	NR	B1
Stone	J	H			04/09/1872	02/22/1950	NR	B1
Stone	Sallie	Ruark			07/21/1911	01/02/1912	NR	B1
Stone	Zillah				10/18/1908	10/01/1909	NR	B1
Strickland	Alice				00/00/1906	00/00/1973	BN	D5
Strickland	Alice	McDonald			00/00/1906	00/00/1975	BN	D5
Strickland	Hector	B			00/00/1890	00/00/1961	BN	D5
Strickland	Hector	B			00/00/1890	00/00/1961	BN	D5
Strickland	Mary	S	Paterson		00/00/0000	00/00/0000	BN	D5
Strickland	Robert	Hector			00/00/0000	00/00/0000	BN	D5
Strickland	William	James	McDonald		00/00/0000	00/00/0000	BN	D5
Stuart	Kate				08/17/1844	04/13/1929	MR	F4
Stuart	Mary	E			01/01/1795	03/23/1884	MR	F4
Swain	Eliza	Ann			00/00/0000	11/03/1891	BN	G6
Swain	Gertrude	B			00/00/1881	00/00/1933	BN	C4
Swain	Margaret	Jane			02/04/1848	12/02/1903	MR	G6
Swain	Margaret	Jane			02/04/1855	12/02/1903	NR	A5
Swain	Mary				12/07/1842	04/05/1938	MR	D3
Swain	R.	Clyde			00/00/1880	00/00/1952	BN	C4



Last Name	First Name	Middle/Initial	Other Mid Name	Other Title	Birth Date	Death Date	Quad Loc	Loc
Swain	Samuel	P			02/01/1838	10/21/1906	BN	G6
Swain	William				02/12/1827	01/31/1895	MR	D3
Swan	Bessie	F.			08/26/1890	01/03/1867	NR	F5
Swan	Caroline	A			00/00/1833	06/19/1891	NR	F5
Swan	Charles	N			08/19/1873	09/27/1864	NR	F5
Swan	Ethel	Theresa			11/23/1909	05/28/1987	NR	F5
Swan	Henry	G.			00/00/1830	00/00/1901	NR	F5
Swan	Mabel	B			02/01/1918	05/01/1918	NR	F5
Swan	Marie	R			01/07/1873	12/15/1915	NR	F5
Swan	Marie	Rose			01/17/1875	12/16/1915	NR	F5



## T Last Name

Last Name	First Name	Middle Initial	Other Mid Name	Other Title	Birth Date	Death Date	Quad Loc	Loc
Taylor	Alfred	D			00/00/1826	00/00/1865	MR	F5
Taylor	Annis				00/00/1795	09/05/1858	MR	F5
Taylor	C.	Edward			09/15/1875	10/16/1944	BM	A7
Taylor	Emeline	L			06/23/1823	12/24/1853	BN	H4
Taylor	George				08/04/1816	12/24/1853	BN	H4
Taylor	Jesse	Stevens			09/26/1879	11/18/1961	BM	A7
Taylor	Richard				08/15/1795	07/17/1851	MR	F5
Tharp	Ethleen				08/24/1892	01/09/1893	NR	F4
Tharp	Nancy	A			02/24/1860	03/08/1914	BN	D6
Tharp	Oscar	O			11/05/1877	10/04/1880	MR	D1
Tharp	Paxton	C			02/22/1859	02/22/1937	NR	F4
Tharp	Priscilla				08/02/1884	12/14/1909	NR	F4
Tharp	Samuel	A			03/27/1848	06/18/1907	MR	E1
Tharp	Sarah				05/02/1859	00/00/0000	NR	F4
Tharp	Wilbon	Hughes			06/01/1917	06/03/1967	BN	D6
Tharp	William	McGlentic			11/03/1901	02/06/1902	NR	F4
Thomas	Rebecca				11/12/1795	01/07/1882	BN	F5
Thompson	Ann	Buttler			12/22/1877	06/28/1956	NR	G1
Thompson	Cecil	Arrington			10/03/1881	04/04/1934	BM	A8
Thompson	Curtis				12/15/1868	10/15/1876	NR	G1
Thompson	Emma	Carroll			00/00/0000	00/00/0000	NR	G1
Thompson	Emma	G.			02/12/1846	09/19/1930	BM	A5
Thompson	Evelyn				00/00/0000	00/00/0000	NR	G1
Thompson	Evelyn	Young			08/03/1913	11/15/1997	MR	E3
Thompson	Harry	Kidder			00/00/0000	00/00/0000	NR	G1
Thompson	James	W			01/28/1875	02/05/1942	NR	G1
Thompson	John	Harper			00/00/1879	00/00/1937	NR	G1
Thompson	John	Jacob			03/17/1850	08/12/1911	BM	A8
Thompson	Joseph	T			05/06/1845	12/06/1909	BM	A5
Thompson	Mary	Eliza			00/00/1839	00/00/1881	NR	G1
Thompson	Mary	Stuart	Newton		10/10/1881	09/23/1953	NR	A3
Thompson	Maryon	Medway			00/00/0000	00/00/0000	NR	G1
Thompson	Mike	G.			00/00/1872	00/00/1944	BM	B4
Thompson	Molly	D			00/00/1869	00/00/1930	BM	B4
Thompson	Rebecca	Waker			09/02/1848	02/27/1924	BM	A8
Thompson	Richard				10/11/1903	07/17/1906	BM	A5
Thompson	Robert	L			04/14/1877	03/11/1968	NR	A3
Thompson	Sarah	Amelia			00/00/1848	00/00/1913	NR	G1
Thompson	Thomas				00/00/0000	00/00/0000	NR	G1
Thompson	Thomas	Mann		Jr	00/00/1867	00/00/1916	NR	G1
Thompson	Thomas	Mann			10/13/1859	01/31/1863	NR	G1
Thompson	Thomas	Mann			00/00/1831	00/00/1907	NR	G1
Thompson	Walter	Black			03/21/1877	12/08/1878	NR	G1
Thompson	Waters				04/19/1909	06/19/1966	NR	A3



Last Name	First Name	Middle Initial	Other Mid Name	Other Title	Birth Date	Death Date	Quad Loc	Loc
Thompson	William	C		Sr	12/29/1876	03/25/1944	BM	A5
Thorsen	Lenna	Alfred			04/17/1928	12/17/1993	BM	C3
Thorsen	Peter	Ednar			00/00/1957	00/00/1957	BM	D3
Thweatt	Hattie	Fulchar			00/00/1878	00/00/1969	BN	C6
Tobiasen	Inga				10/09/1864	04/05/1940	NR	C6
Tobiasen	Knub				05/22/1866	02/23/1953	NR	C6
Tobiasen	Thoralph	Johan			11/18/1902	10/02/1989	NR	C6
Trout	John	D			04/01/1848	12/11/1872	MR	B3
Trunnell	Albert				00/00/1871	00/00/1909	MR	E3
Tydings	Alice	Adkins			11/12/1894	08/10/1957	NR	D5
Tydings	Donald	S		NF1990	00/00/1881	10/07/1945	NR	D5



## U - V Last Name

Last Name	First Name	Middle/Initial	Other Mid Name	Other Title	Birth Date	Death Date	Quad Loc	Loc
Unknown					00/00/0000	00/00/0000	BM	A6
Unknown					00/00/0000	00/00/0000	BM	C3
Unknown					00/00/0000	00/00/0000	BM	D8
Unknown					00/00/0000	00/00/0000	BM	E4
Unknown					00/00/0000	00/00/0000	BN	A7
Unknown					00/00/0000	00/00/0000	BN	D5
Unknown					00/00/0000	00/00/0000	BN	D5
Unknown					00/00/0000	00/00/0000	BN	D6
Unknown					00/00/0000	00/00/0000	BN	E5
Unknown					00/00/0000	00/00/0000	BN	E6
Unknown					00/00/0000	00/00/0000	BN	H3
Unknown					00/00/0000	00/00/0000	BN	H4
Unknown					00/00/0000	00/00/0000	BN	H7
Unknown					00/00/0000	00/00/0000	BN	H7
Unknown					00/00/0000	00/00/0000	BN	I6
Unknown					00/00/0000	00/00/0000	MR	B5
Unknown					00/00/0000	00/00/0000	MR	E3
Unknown					00/00/0000	00/00/0000	NR	D6
Unknown					00/00/0000	00/00/0000	NR	F2
Unknown					00/00/0000	00/00/0000	NR	F5
Unknown					00/00/0000	00/00/0000	NR	F6
Unknown					00/00/0000	00/00/0000	NR	G1
Unknown	Ada				00/00/0000	00/00/0000	MR	F2
Unknown	Alice				00/00/1848	10/00/1860	BM	A3
Unknown	Can't Read				00/00/0000	00/00/0000	BN	H3
Unknown	Children				00/00/0000	00/00/0000	BM	E2
Unknown	Children				00/00/0000	00/00/0000	BM	E2
Unknown	Crypt				00/00/0000	00/00/0000	MR	E4
Unknown	Lot				00/00/0000	00/00/0000	BN	D5
Unknown	Not found 2011				00/00/0000	00/00/0000	BN	A8
Unknown	Not found 2011				00/00/0000	00/00/0000	BN	D3
Unknown	Sally				00/00/1816	03/22/1851	BM	A3
Unknown	(Fullwood)				00/00/0000	00/00/0000	BN	G1
Unmarked					00/00/0000	00/00/0000	BM	D8
Unmarked					00/00/0000	00/00/0000	BM	E3
Unmarked					00/00/0000	00/00/0000	BN	D4
Unmarked					00/00/0000	00/00/0000	BN	H3
Unmarked					00/00/0000	00/00/0000	BN	H3
Unmarked					00/00/0000	00/00/0000	MR	C6
Unmarked					00/00/0000	00/00/0000	MR	F1
Unmarked					00/00/0000	00/00/0000	MR	F1
Unmarked					00/00/0000	00/00/0000	MR	F1
Unmarked					00/00/0000	00/00/0000	NR	E3
Unmarked					00/00/0000	00/00/0000	NR	E3
Unmarked	3 of	them			00/00/0000	00/00/0000	NR	D2
Unmarked	Block	Boundry			00/00/0000	00/00/0000	MR	D1
Unmarked	Pipes	Boundry			00/00/0000	00/00/0000	MR	E2



Unmarked	Unknown		00/00/0000	00/00/0000	MR	B2
Unmarked	Unknown		00/00/0000	00/00/0000	MR	B6
Unmarked	Unknown		00/00/0000	00/00/0000	MR	B7
Unmarked			00/00/0000	00/00/0000	NR	F5
Unmarked			00/00/0000	00/00/0000	BM	B1
Unmarked	Not found 2011		00/00/0000	00/00/0000	BM	E1
Unmarked	Not found-2011		00/00/0000	00/00/0000	BM	E1
Vernon	Annie	Margaret	07/15/1832	11/25/1917	MR	F5
Vernon	Mabel	F	05/17/1859	02/05/1860	MR	G5
Vest	Margaret	Trunnell	00/00/1872	00/00/1935	MR	E3
Vitou	Annie	K	07/02/1882	10/29/1967	MR	A6



## W - Y Last Name

Last Name	First Name	Middle/Initial	Other Mid Name	Other Title	Birth Date	Death Date	Quad Loc	Loc
Wade	Stacey	W			02/28/1899	04/06/1976	BM	F3
Wade	Stella	W			00/00/1873	00/00/1935	BM	F3
Wade	Virginia	Thompson			00/00/1905	00/00/1963	BM	B4
Wade	William	B			00/00/1873	00/00/1952	BM	F3
Walker	Claude				10/04/1875	08/30/1877	MR	A2
Walker	George				00/00/0000	00/00/0000	BM	E5
Walker	Robert	S			04/01/1844	04/13/1877	MR	B3
Walker	Sarah	A			07/02/1849	06/05/1916	BM	E5
Ward	Doris	Corlette	Harrison		04/10/1921	02/27/1990	BN	D2
Ward	Doris	Corlette	Harrelson		04/11/1923	02/27/1990	BN	D2
Ward	Hugh	D		MD	08/24/1885	02/18/1919	NR	A3
Warren	Annie	Little			00/00/0000	00/00/0000	MR	F3
Warren	Eddie	G.			01/28/1871	11/10/1900	MR	G3
Warren	Elizabeth				06/20/1827	12/14/1900	MR	F3
Warren	John				05/24/1812	08/22/1877	MR	F3
Warren	Johnny	"our"			00/00/0000	00/00/0000	MR	F2
Watson	Archie	C			00/00/1893	00/00/1964	BM	A6
Watson	Bessie	D.			05/12/1887	09/16/1940	BM	A4
Watson	Charles	Drew			08/27/1920	04/23/1936	BM	A4
Watson	Duncan	C			10/09/1889	03/15/1891	BM	A6
Watson	Duncan	I			11/23/1856	05/27/1939	BM	A6
Watson	Genevieve	Danford			04/28/1912	02/18/2009	BM	A4
Watson	George	Y.			10/23/1881	03/12/1920	BM	A3
Watson	Ida	Potter	Manson		07/19/1880	03/07/1962	BM	A3
Watson	Isham	E			05/16/1886	12/15/1931	BM	A4
Watson	John	Moody			05/01/1894	03/02/1920	BM	A6
Watson	Louise	C			00/00/1885	00/00/1948	BM	A6
Watson	Maggie	Moody			10/14/1855	05/10/1930	BM	A6
Watson	Marion	Manson			07/16/1910	03/05/1994	BM	A3
Watts	Annie	M			02/27/1873	05/21/1938	BN	E6
Watts	Crawford	W.			11/05/1866	06/11/1923	BN	E6
Watts	Essie	Dosher			00/00/1855	00/00/1933	BN	F1
Watts	George	Walker			12/17/1888	04/28/1889	NR	F2
Watts	Harriet	E.			02/02/1828	07/22/1890	NR	F2
Watts	Howard	Crawford			06/26/1898	07/03/1969	BN	E6
Watts	J	L			11/18/1854	08/03/1911	BN	F1
Watts	Laura	Southerland			02/21/1901	08/28/1979	BN	E3
Watts	Olie				07/01/1866	03/04/1896	BM	D6
Watts	S.	W.			04/16/1826	10/06/1881	NR	F2
Watts	Samuel	F			05/01/1900	12/16/1953	BN	E3
Watts	Taus				05/16/1864	02/15/1882	NR	F2
Webb	Claudia	K			00/00/1940	00/00/2008	BN	B1
Webb	Kathleen	M			11/17/1918	03/11/1993	BN	B1
Webb	Virginia	P			06/21/1937	00/00/0000	BN	B1
Webb	W	C			05/18/1918	05/24/1985	BN	B1
Webb	William	Delanor			06/20/1937	05/24/1999	BN	B1
Weeks	Angie	Mazella			07/08/1883	06/22/1917	BM	F6
Weeks	Annie	Dell			08/05/1888	07/04/1906	BM	F6
Weeks	Carrie	D	Drew		08/21/1876	03/21/1894	BM	F6



Last Name	First Name	Middle/Initial	Other Mid Name	Other Title	Birth Date	Death Date	Quad Loc	Loc
Weeks	Irene	T			00/00/1874	00/00/1932	BM	F6
Weeks	J	J			12/26/1878	11/02/1940	BN	I7
Weeks	John	Julius			01/04/1847	03/26/1916	BM	E6
Weeks	Mary	A.			02/14/1850	06/23/1920	BM	E6
Weeks	Mary	L			02/18/1882	05/25/1944	BN	G6
Weeks	Mary	Louise			09/27/1852	02/06/1933	BN	G6
Weeks	Viola	Mazella			06/28/1899	09/17/1899	BM	F6
Weeks	Walker	N			00/00/1878	00/00/1922	BN	G6
Weeks	William				08/15,1850	01/24/1927	BN	G6
Weeks	William	Jesse			00/00/1871	00/00/1931	BM	F6
Wells	Victoria	Marran			08/24/1915	02/23/2002	BN	B4
Wells	Wiley	Gordon			09/20/1914	01/07/1975	BN	B4
Wescott	John	S			01/02/1856	01/05/1886	MR	F2
Wescott	John	L			05/26/120	08/05/1896	NR	B5
Wescott	Lydia				01/01/1807	05/10/1900	NR	B5
Wescott	Maggie				05/28/1828	03/14/1908	NR	B2
Wescott	Morita	Worth			08/01/1887	09/27/1888	NR	B5
Wescott	Unknown				03/01/1902	05/26/1905	NR	B5
Whitehurst	Gladys	Irene			03/10/1901	03/15/1901	BN	B6
Wilkins	Horace	Seba			11/17/1922	03/01/1997	BN	E4
Willetts	V.	D.			00/00/1911	00/00/1987	BM	C8
Williams	Edgar				01/01/1820	02/23/1863	MR	E4
Williams	Edward	Hall			01/06/1882	11/11/1907	NR	D3
Williams	Frank	H			00/00/0000	01/22/1910	NR	D3
Williams	James	Allison			02/25/1845	04/10/1930	NR	D3
Williams	Lillie	M			02/27/1877	06/03/1959	BM	E8
Williams	Mary	Elizabeth			12/04/1850	03/31/1904	NR	D3
Williams	Sarah	A			01/01/1821	02/15/1862	MR	E4
Willing	Addie	Young			07/28/1878	04/30/1953	BN	I1
Willing	Claude	R			01/03/1876	11/15/1930	BN	I1
Willis	Edwin	Olistine			02/14/1867	10298	BM	B1
Willis	H.	Stuart	K		07/19/1891	03/19/1986	MR	D2
Willis	Jeanette				05/26/1891	07/02/1953	MR	D2
Willis	Lovey	Dixson			03/23/1872	01/22/1934	BM	D1
Willis	William	Tice			01/17/1875	06/11/1939	BM	D1
Wilson	Victor	Norriss			06/30/1914	02/07/1929	BM	C4
Winder	Thomas	Cox			07/25/1836	07/10/1837	BM	D7
Windsor	Millard				08/01/1878	06/10/1940	MR	G1
Windsor	Nathan				01/01/1849	06/23/1910	MR	G1
Windsor	Sarah	A			04/02/1849	12/09/1924	MR	G1
Winslow	Ada				00/00/0000	00/00/0000	MR	F2
Winslow	Albert				00/00/0000	00/00/0000	MR	F2
Winslow	Russel				00/00/0000	00/00/0000	MR	F2
Winslow	Virginia	Morse			11/11/1911	08/06/1978	MR	F2
Wolfe	Eva	P.			04/27/1895	02/04/1988	BM	D2
Wolfe	Joseph	P			12/15/1894	12/04/1921	BM	D2
Woodlock	Emma	Josephine			03/31/1871	09/26/1876	MR	A1
Woodlock	Esther	Sarah			12/04/1873	08/29/1876	MR	A1
Woodlock	John				00/00/0000	10/30/1876	MR	A2
Woodlock	Marion				10/15/1866	09/28/1876	MR	A2
Woodside	Annie	May			09/26/1892	02/02/1981	NR	C1







Last Name	First Name	Middle/Initial	Other Mid Name	Other Title	Birth Date	Death Date	Quad Loc	Loc
Woodside	Berta	Keal			04/17/1877	06/24/1958	BN	G7
Woodside	John	W			02/22/1821	04/05/1884	NR	D1
Woodside	John	W			02/09/1858	09/27/1895	NR	D1
Woodside	Mary	Lizzie			08/21/1890	05/12/1894	NR	C1
Woodside	R	Thurston			01/27/1911	01/17/1912	BN	G7
Woodside	Robert	T			09/22/1881	04/20/1960	BN	G7
Yaskell	Leonard	T			11/04/1898	11/26/1986	NR	G4
Yaskell	Louise	Standland			08/02/1899	06/01/1991	NR	G4